

Compatibile con/Similar to

E3180

Materiale/Material

lega bronzo con lubrificante solido grafite
bronze alloy with solid graphite lubricant

| b | S | |
|----|----|---|
| 25 | 6 | • |
| 40 | | • |
| 63 | 8 | • |
| 80 | 10 | • |

* si realizzano misure su richiesta

Esempio ordine: CODICE + b
N3180 25
N318025

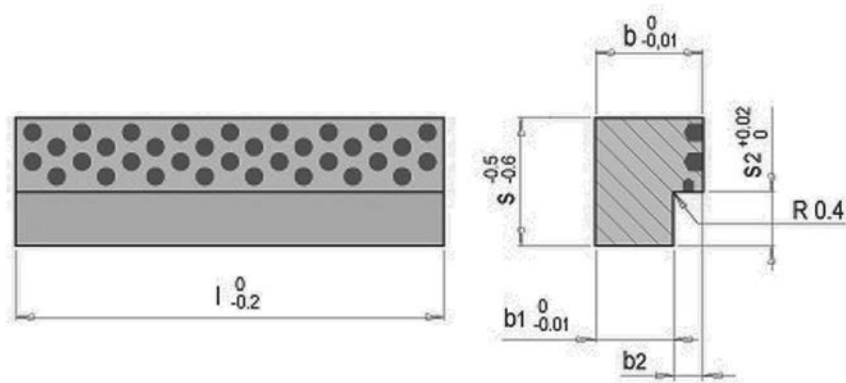

**Elemento di scorrimento
bronzo grafite**
Bronze graphite guide
Codice/Code N3118

Compatibile con/Similar to

E3118

Materiale/Material

lega bronzo con lubrificante solido grafite
bronze alloy with solid graphite lubricant

| s | s2 | l | t1 | t2 | t3 | M | b4 | b | b1 | b2 | |
|----|----|-----|----|----|----|-----|----|----|----|----|---|
| 12 | 6 | 40 | 10 | 4 | 2 | M 5 | 6 | 16 | 12 | 4 | • |
| | | 50 | | | | | | | | | • |
| | | 63 | | | | | | | | | • |
| | | 80 | | | | | | | | | • |
| 16 | 8 | 50 | 13 | 5 | 3 | M 5 | 6 | 16 | 11 | 5 | • |
| | | 63 | | | | | | | | | • |
| | | 80 | | | | | | | | | • |
| | | 100 | | | | | | | | | • |
| 20 | 8 | 63 | 17 | 5 | 3 | M 6 | 9 | 20 | 15 | 5 | • |
| | | 80 | | | | | | | | | • |
| | | 100 | | | | | | | | | • |
| | | 125 | | | | | | | | | • |
| 20 | 11 | 63 | 17 | 8 | 3 | M 6 | 9 | 20 | 15 | 5 | • |
| | | 80 | | | | | | | | | • |
| | | 100 | | | | | | | | | • |
| | | 125 | | | | | | | | | • |
| 25 | 8 | 80 | 22 | 5 | 3 | M 6 | 9 | 20 | 15 | 5 | • |
| | | 100 | | | | | | | | | • |
| | | 125 | | | | | | | | | • |
| | | 160 | | | | | | | | | • |
| 25 | 13 | 80 | 22 | 10 | 3 | M 6 | 9 | 20 | 15 | 5 | • |
| | | 100 | | | | | | | | | • |
| | | 125 | | | | | | | | | • |
| | | 160 | | | | | | | | | • |

| s | s2 | l | t1 | t2 | t3 | M | b4 | b | b1 | b2 | |
|----|----|-----|----|----|----|-----|----|----|----|----|---|
| 32 | 10 | 100 | 28 | 6 | 4 | M 8 | 11 | 25 | 19 | 6 | • |
| | | 125 | | | | | | | | | • |
| | | 160 | | | | | | | | | • |
| | | 200 | | | | | | | | | • |
| 32 | 16 | 100 | 28 | 12 | 4 | M 8 | 11 | 25 | 19 | 6 | • |
| | | 125 | | | | | | | | | • |
| | | 160 | | | | | | | | | • |
| | | 200 | | | | | | | | | • |
| 40 | 10 | 125 | 36 | 6 | 4 | M 8 | 11 | 25 | 19 | 6 | • |
| | | 160 | | | | | | | | | • |
| | | 200 | | | | | | | | | • |
| | | 250 | | | | | | | | | • |
| 40 | 16 | 125 | 36 | 12 | 4 | M 8 | 11 | 25 | 19 | 6 | • |
| | | 160 | | | | | | | | | • |
| | | 200 | | | | | | | | | • |
| | | 250 | | | | | | | | | • |
| 50 | 12 | 160 | 46 | 8 | 4 | M10 | 14 | 32 | 24 | 8 | • |
| | | 200 | | | | | | | | | • |
| | | 250 | | | | | | | | | • |
| | | 315 | | | | | | | | | • |
| 50 | 20 | 160 | 46 | 16 | 4 | M10 | 14 | 32 | 24 | 8 | • |
| | | 200 | | | | | | | | | • |
| | | 250 | | | | | | | | | • |
| | | 315 | | | | | | | | | • |

Esempio ordine: CODICE + s x s2 x l
N3118 12 x 6 x 40
N311812640

* si realizzano misure su richiesta

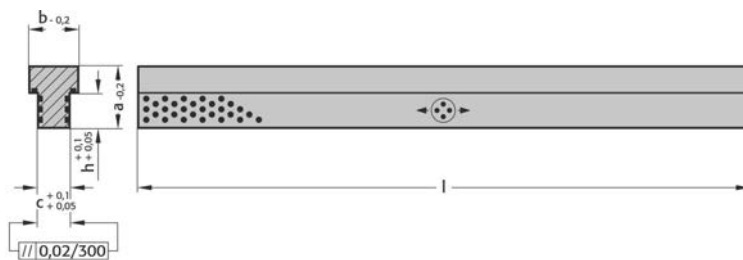

Listello di scorrimento a "T"

T guide bar

Codice/Code **N2964.77**

Compatibile con/Similar to

2964.77

Materiale/Material

lega bronzo con lubrificante solido grafite
bronze alloy with solid graphite lubricant

| a | b | c | h | l | |
|----|----|----|----|-----|---|
| 12 | 18 | 8 | 5 | 350 | • |
| 25 | 22 | 12 | 15 | | • |
| 35 | 28 | 18 | 20 | | • |

* si realizzano misure su richiesta

Esempio ordine: CODICE + a x b x l
N2964.77 25 x 22 x 350
N2964772522350

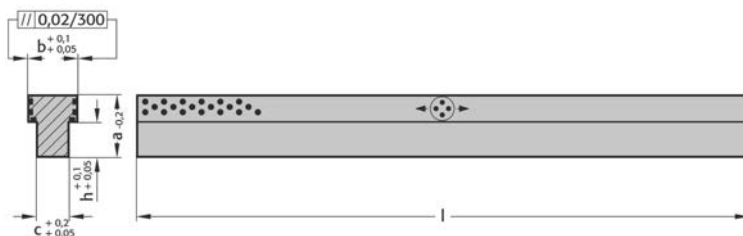

Listello di scorrimento a "T"

T guide bar

Codice/Code **N2964.78**

Compatibile con/Similar to

2964.78

Materiale/Material

lega bronzo con lubrificante solido grafite
bronze alloy with solid graphite lubricant

| a | b | c | h | l | |
|----|----|----|----|-----|---|
| 12 | 18 | 8 | 5 | 350 | • |
| 25 | 22 | 12 | 15 | | • |
| 35 | 28 | 18 | 20 | | • |

* si realizzano misure su richiesta

Esempio ordine: CODICE + a x b x l
N2974.78 12 x 18 x 350
N2974781218350

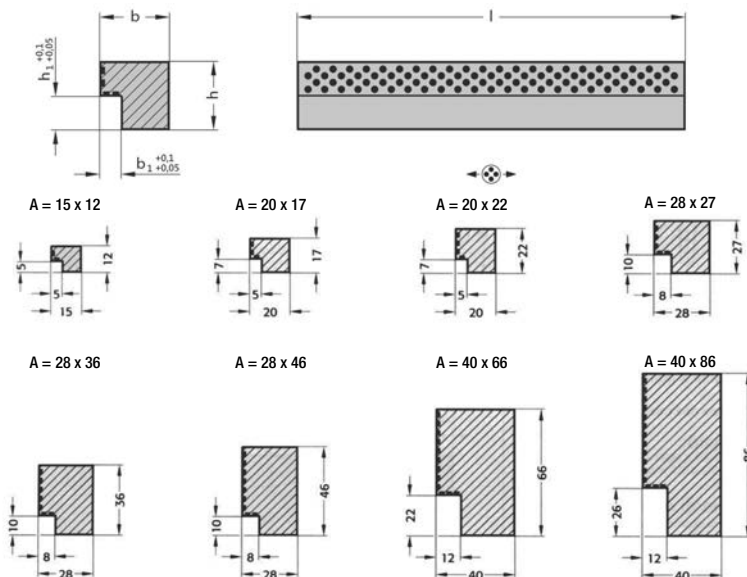

**Elemento di scorrimento
angolare**
Angled guide gib
Codice/Code N2962.72

Compatibile con/Similar to

2962.72; SOVL

Materiale/Material

lega bronzo con lubrificante solido grafite
bronze alloy with solid graphite lubricant

| A= Dimensioni Dimensions | L = Lunghezza/Length | | |
|-----------------------------|----------------------|-----|-----|
| | 205 | 320 | 605 |
| 15 x 12 | • | | |
| 20 x 17 | • | • | |
| 20 x 22 | • | • | |
| 28 x 27 | • | • | • |
| 28 x 36 | • | • | • |
| 28 x 46 | • | • | • |
| 40 x 66 | • | • | • |
| 40 x 86 | • | • | • |

* si realizzano misure su richiesta

Esempio ordine: CODICE + A x L
N2962.72 15 x 12 x 205
N2962721512205

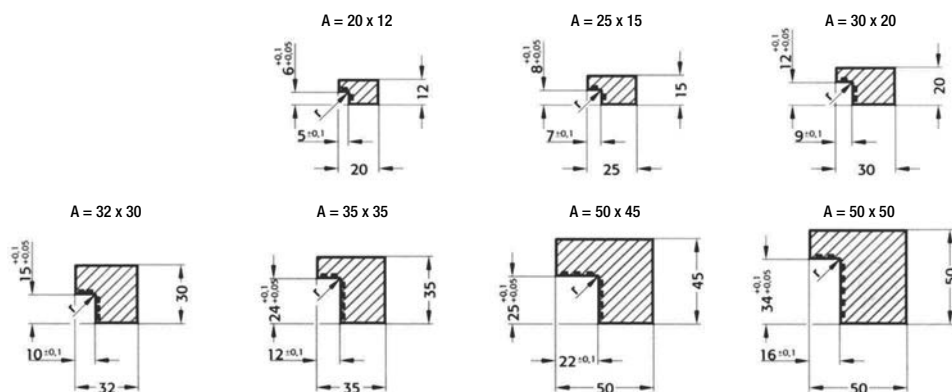

**Elemento di scorrimento
angolare**
Angled guide gib
Codice/Code N2962.71

Compatibile con/Similar to

2962.71; SOL-1-7

Materiale/Material

lega bronzo con lubrificante solido grafite
bronze alloy with solid graphite lubricant

| A= Dimensioni Dimensions | L = Lunghezza/Length | | |
|-----------------------------|----------------------|-----|------|
| | 305 | 605 | 1005 |
| 20 x 12 | • | | |
| 25 x 15 | • | | |
| 30 x 20 | • | | |
| 32 x 30 | | • | • |
| 35 x 35 | | • | • |
| 50 x 45 | | • | • |
| 50 x 50 | | • | • |

* si realizzano misure su richiesta

Esempio ordine: CODICE + A x L
N2962.71 20 x 12 x 305
N2962712012305

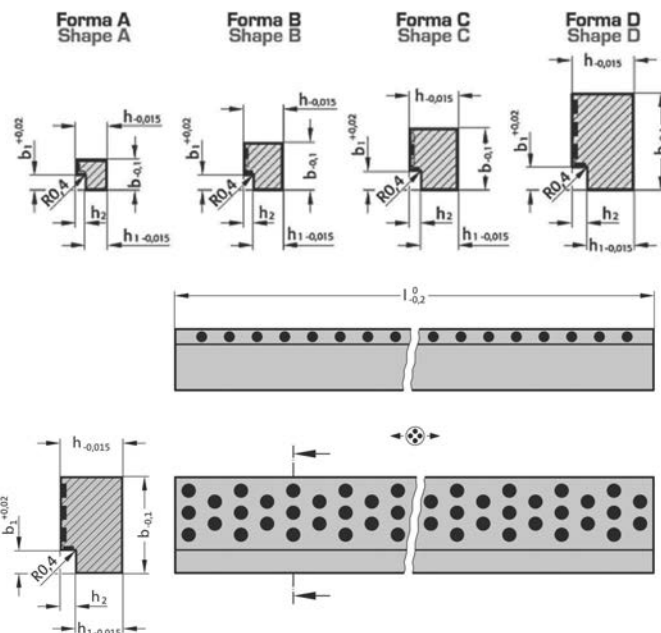

**Elemento di scorrimento
angolare**

Angled guide gib

Codice/Code N2962.81

Compatibile con/Similar to

2962.81

Materiale/Material

lega bronzo con lubrificante solido grafite
bronze alloy with solid graphite lubricant

| h | b | l | h1 | h2 | b1 | Forma/Shape | |
|------|------|-----|----|----|----|-------------|---|
| 16 | 11,5 | 40 | 12 | 4 | 6 | A | • |
| | | 50 | | | | | • |
| | | 63 | | | | | • |
| | | 80 | | | | | • |
| 15,5 | 15,5 | 50 | 11 | 5 | 8 | | • |
| | | 63 | | | | | • |
| | | 80 | | | | | • |
| | | 100 | | | | | • |
| 19,5 | 19,5 | 63 | 15 | 5 | 8 | • | |
| | | 80 | | | | • | |
| | | 100 | | | | • | |
| | | 125 | | | | • | |
| 24,5 | 24,5 | 80 | 15 | 5 | 8 | • | |
| | | 100 | | | | • | |
| | | 125 | | | | • | |
| | | 160 | | | | • | |
| 31,5 | 31,5 | 100 | 19 | 6 | 10 | • | |
| | | 125 | | | | • | |
| | | 160 | | | | • | |
| | | 200 | | | | • | |
| 39,5 | 39,5 | 125 | 19 | 6 | 10 | • | |
| | | 160 | | | | • | |
| | | 200 | | | | • | |
| | | 250 | | | | • | |
| 49,5 | 49,5 | 160 | 24 | 8 | 12 | • | |
| | | 200 | | | | • | |
| | | 250 | | | | • | |
| | | 315 | | | | • | |

* si realizzano misure su richiesta

Esempio ordine: CODICE + h x b x l
N2962.81 16 x 11,5 x 40
N2962811611,540

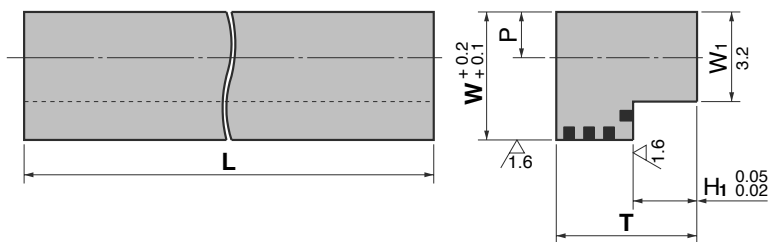

Compatibile con/Similar to

SGLX

Materiale/Material

lega bronzo con lubrificante solido grafite
bronze alloy with solid graphite lubricant

| W | L | T | W ₁ | H | Recommended mounting holes | | |
|----|-----|----|----------------|----|----------------------------|------|---|
| | | | | | P | Size | |
| 20 | 320 | 15 | 14.5 | 5 | 8 | M8 | • |
| | | 20 | | | | | • |
| | | 25 | | | | | • |
| | | 23 | | | | | • |
| | | 28 | | | | | • |
| 25 | 320 | 28 | 17.5 | 10 | 10 | M8 | • |
| | | 33 | | | | | • |
| | | 43 | | | | | • |
| 30 | 320 | 38 | 19 | 15 | 10 | M8 | • |
| | | 43 | | | | | • |
| 35 | 605 | 53 | 23 | 15 | 12 | M10 | • |
| | | 43 | | | | | • |
| | | 53 | | | | | • |
| 40 | 605 | 63 | 28 | 20 | 14 | M12 | • |
| | | 45 | | | | | • |
| | | 55 | | | | | • |
| | | 65 | | | | | • |

Esempio ordine: CODICE + W x L x T
NSGLX 20 x 320 x 15
NSGLX2032015

* si realizzano misure su richiesta

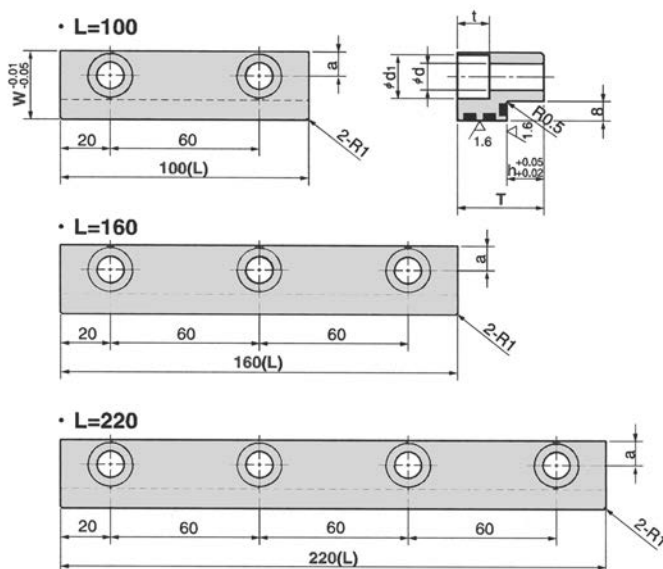

Guide bronzo grafite
Bronze graphite guide
Codice/Code NSGLDW

Compatibile con/Similar to

SGLDW

Materiale/Material

lega bronzo con lubrificante solido grafite
bronze alloy with solid graphite lubricant

| L | | | T | W | h | a | d1 | d | t | |
|-----|-----|-----|----|----|----|-----|----|----|----|---|
| 100 | 160 | 220 | 30 | 23 | 15 | 7,5 | 11 | 7 | 7 | • |
| | | | 41 | | 26 | | | | | • |
| | | | 25 | 28 | 10 | 10 | 18 | 11 | 13 | • |
| | | | 35 | | 15 | | | | | • |
| | | | 56 | | 26 | | | | | • |

Esempio ordine: CODICE + W x L x T
NSGLDW 23 x 160 x 41
NSGLDW2316041

* si realizzano misure su richiesta

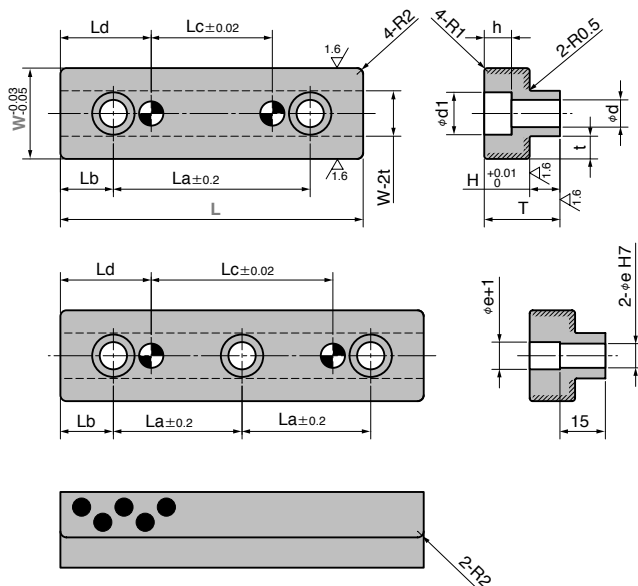

Guide bronzo grafite
Bronze graphite guide
Codice/Code NTGLWN

Compatibile con/Similar to

TGLWN

Materiale/Material

lega bronzo con lubrificante solido grafite
bronze alloy with solid graphite lubricant

| W | L | La | Lb | Lc | Ld | T | H | t | d | d ₁ | H | |
|----|-----|------|------|-----|------|----|----|-----|-----|----------------|----|---|
| 20 | 60 | 35 | 12.5 | 15 | 22.5 | 15 | 8 | 4.5 | 5.5 | 9.5 | 6 | • |
| | 80 | 55 | | 35 | | | | | | | | • |
| | 100 | 75 | | 55 | | | | | | | | • |
| 25 | 80 | 50 | 15 | 20 | 30 | 20 | 8 | 5.5 | 6.5 | 11 | 7 | • |
| | 100 | 70 | | 40 | | | | | | | | • |
| | 120 | 45 | | 60 | | | | | | | | • |
| 30 | 100 | 65 | 17.5 | 40 | 30 | 25 | 10 | 7.5 | 9 | 14 | 9 | • |
| | 120 | 42.5 | | 60 | | | | | | | | • |
| | 140 | 52.5 | | 80 | | | | | | | | • |
| 40 | 120 | 40 | 20 | 40 | 40 | 30 | 15 | 11 | 11 | 18 | 11 | • |
| | 140 | 50 | | 60 | | | | | | | | • |
| | 160 | 60 | | 80 | | | | | | | | • |
| | 180 | 70 | | 100 | | | | | | | | • |

* si realizzano misure su richiesta

Esempio ordine: CODICE + W x L
NTGLWN 25 x 120
NTGLWN25120

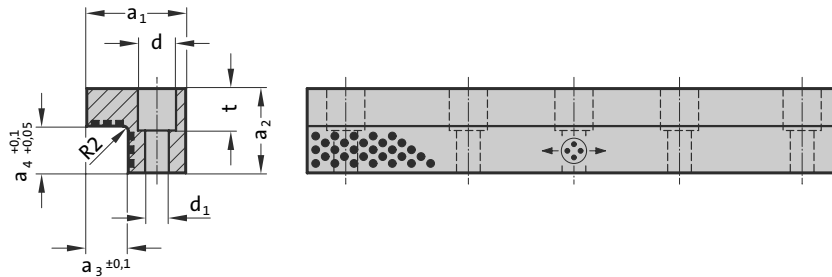
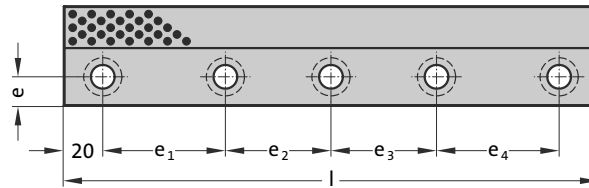

Compatibile con/Similar to

2962.70; S0L

Materiale/Material

lega bronzo con lubrificante solido grafite
bronze alloy with solid graphite lubricant

| a1 | a2 | l | a3 | a4 | e | e1 | e2 | e3 | e4 | d | d1 | t | Numero fori Holes n. | |
|----|----|-----|----|----|----|----|----|----|----|----|----|-----|----------------------|---|
| 26 | 20 | 100 | 8 | 10 | 9 | 60 | - | - | - | 15 | 9 | 9.6 | 2 | • |
| 26 | 20 | 150 | 8 | 10 | 9 | 55 | 55 | - | - | 15 | 9 | 9.6 | 3 | • |
| 26 | 20 | 200 | 8 | 10 | 9 | 55 | 50 | 55 | - | 15 | 9 | 9.6 | 4 | • |
| 32 | 30 | 100 | 10 | 15 | 11 | 60 | - | - | - | - | 11 | - | 2 | • |
| 32 | 30 | 150 | 10 | 15 | 11 | 55 | 55 | - | - | - | 11 | - | 3 | • |
| 32 | 30 | 200 | 10 | 15 | 11 | 55 | 50 | 55 | - | - | 11 | - | 4 | • |
| 32 | 30 | 250 | 10 | 15 | 11 | 70 | 70 | 70 | - | - | 11 | - | 4 | • |
| 50 | 45 | 200 | 22 | 25 | 14 | 55 | 50 | 55 | - | 18 | 11 | 25 | 4 | • |
| 50 | 45 | 250 | 22 | 25 | 14 | 70 | 70 | 70 | - | 18 | 11 | 25 | 4 | • |
| 50 | 45 | 300 | 22 | 25 | 14 | 65 | 65 | 65 | 65 | 18 | 11 | 25 | 5 | • |
| 50 | 45 | 350 | 22 | 25 | 14 | 80 | 75 | 75 | 80 | 18 | 11 | 25 | 5 | • |

* si realizzano misure su richiesta

Esempio ordine: CODICE + a1 x l
N2962.70 32 x 200
N29627032200

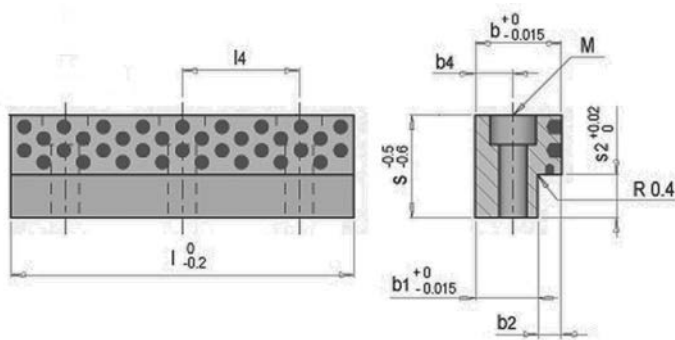

**Elemento di scorrimento
bronzo grafite**
Angle guide bronze graphite
Codice/Code N3119

Compatibile con/Similar to

E3119

Materiale/Material

lega bronzo con lubrificante solido grafite
bronze alloy with solid graphite lubricant

| S | S2 | l | t1 | t2 | t3 | M | A | b4 | l4 | b | b1 | b2 | |
|----|----|-----|----|----|----|-----|---|----|------|----|----|----|---|
| 12 | 6 | 40 | 10 | 4 | 2 | M 5 | 2 | 6 | 24 | 16 | 12 | 4 | • |
| | | 50 | | | | | | | 34 | | | | • |
| | | 63 | | | | | | | 47 | | | | • |
| | | 80 | | | | | | | 32 | | | | • |
| 16 | 8 | 50 | 13 | 5 | 3 | M 5 | 2 | 6 | 34 | 16 | 11 | 5 | • |
| | | 63 | | | | | | | 47 | | | | • |
| | | 80 | | | | | | | 32 | | | | • |
| | | 100 | | | | | | | 42 | | | | • |
| 20 | 8 | 63 | 17 | 5 | 3 | M 6 | 2 | 9 | 43 | 20 | 15 | 5 | • |
| | | 80 | | | | | | | 60 | | | | • |
| | | 100 | | | | | | | 40 | | | | • |
| | | 125 | | | | | | | 52.5 | | | | • |
| 20 | 11 | 63 | 17 | 8 | 3 | M 6 | 2 | 9 | 43 | 20 | 15 | 5 | • |
| | | 80 | | | | | | | 60 | | | | • |
| | | 100 | | | | | | | 40 | | | | • |
| | | 125 | | | | | | | 52.5 | | | | • |
| 25 | 8 | 80 | 22 | 5 | 3 | M 6 | 2 | 9 | 60 | 20 | 15 | 5 | • |
| | | 100 | | | | | | | 40 | | | | • |
| | | 125 | | | | | | | 52.5 | | | | • |
| | | 160 | | | | | | | 70 | | | | • |
| 25 | 13 | 80 | 22 | 10 | 3 | M 6 | 2 | 9 | 60 | 20 | 15 | 5 | • |
| | | 100 | | | | | | | 40 | | | | • |
| | | 125 | | | | | | | 52.5 | | | | • |
| | | 160 | | | | | | | 70 | | | | • |
| 32 | 10 | 100 | 28 | 6 | 4 | M 8 | 2 | 11 | 76 | 25 | 19 | 6 | • |
| | | 125 | | | | | | | 50.5 | | | | • |
| | | 160 | | | | | | | 68 | | | | • |
| | | 200 | | | | | | | 58 | | | | • |
| 32 | 16 | 100 | 28 | 12 | 4 | M 8 | 2 | 11 | 76 | 25 | 19 | 6 | • |
| | | 125 | | | | | | | 50.5 | | | | • |
| | | 160 | | | | | | | 68 | | | | • |
| | | 200 | | | | | | | 58 | | | | • |
| 40 | 10 | 125 | 36 | 6 | 4 | M 8 | 3 | 11 | 50.5 | 25 | 19 | 6 | • |
| | | 160 | | | | | | | 68 | | | | • |
| | | 200 | | | | | | | 58 | | | | • |
| | | 250 | | | | | | | 74 | | | | • |
| 40 | 16 | 125 | 36 | 12 | 4 | M 8 | 3 | 11 | 50.5 | 25 | 19 | 6 | • |
| | | 160 | | | | | | | 68 | | | | • |
| | | 200 | | | | | | | 58 | | | | • |
| | | 250 | | | | | | | 74 | | | | • |
| 50 | 12 | 160 | 46 | 8 | 4 | M10 | 3 | 14 | 64 | 32 | 24 | 8 | • |
| | | 200 | | | | | | | 84 | | | | • |
| | | 250 | | | | | | | 72 | | | | • |
| | | 315 | | | | | | | 93 | | | | • |
| 50 | 20 | 160 | 46 | 16 | 4 | M10 | 3 | 14 | 64 | 32 | 24 | 8 | • |
| | | 200 | | | | | | | 84 | | | | • |
| | | 250 | | | | | | | 72 | | | | • |
| | | 315 | | | | | | | 93 | | | | • |

* si realizzano misure su richiesta

Esempio ordine: CODICE + S x S2 x l
N3119 12 x 6 x 40
N311912640